

## SIGMA SELECT lock card

Select "Lock level" in the menu "Machine setup" and select one of two lock levels.

At level 1, the following functions are locked:

- Menu (except gas test)
- DUO Plus™
- Pulse welding

At level 2, the following functions are locked:

- Menu (except gas test)
- Proces select
- DUO Plus
- Tack welding
- Dialog
- Analog remote control
- Set current

Irrespective of the chosen lock level, it will always be possible to control the machine from a robot interface.

When you insert the lock card, the lock symbol is displayed, indicating that the control panel is locked. To unlock the control panel, reinsert the lock card. The lock symbol is then turned off.

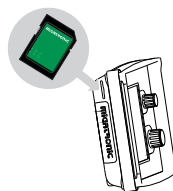
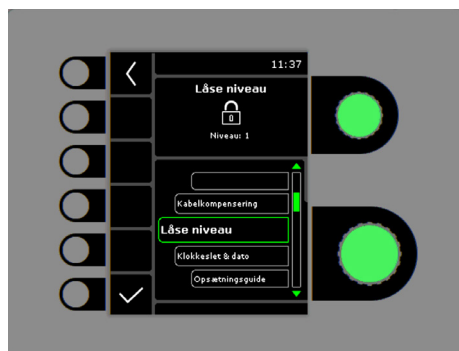

## SIGMA SELECT MigaJOB lock



When a job is selected, it is possible to define a MigaJOB lock, where an AV adjustment limits can be set.

Set current and voltage can be adjusted within the set limits, when the job has been saved, and the lock can be activated by the lock card.

Select "MigaJOB lock" in the setup menu, when the requested job is selected. Define the AV limits.

The MigaJOB lock is activated, when the lock card is inserted and deactivated when the lock card has been reinserted.

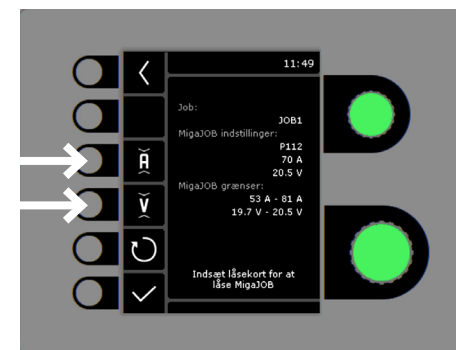

50173735 E2

LIC Licence dependent

MIGATRONIC  
WELDING VALUE

UK

## SIGMA<sup>2</sup>/OMEGA<sup>3</sup> YARD Key lock card

When you insert the Migatronik lock card into the SD card reader of an unlocked control panel, the left and right display will show one of the three available lock levels: **1**, **2** or **ALL**. Use the right control knob to switch between lock levels.

At level 1, the following functions are locked:

### SIGMA<sup>2</sup>

- Secondary parameters
- Program selection
- Change of max. number of sequences
- Error log
- Torch control
- Water cooling configuration
- Pulse
- DUO Plus™

### OMEGA<sup>3</sup> YARD

- Secondary parameters
- Program selection
- Change of max. number of sequences
- Pulse
- DUO Plus™
- User menu (except gas test)

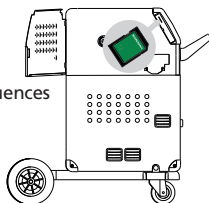

At level 2, the same functions as at level 1 are locked. In addition, the following functions are locked:



- Current / wire feed speed / thickness of material
- Tack welding

At level ALL, the same functions as at level 2 are locked. In addition, the following functions are locked:

- Trim voltage / voltage / choke

Irrespective of the chosen lock level, you can operate the welding machine from a robot interface (if the machine accepts the use of robot interface) and use the following functions:

- Inching
- Gas test
- 2-stroke/4-stroke

When you take out the lock card, the lock symbol  is displayed, indicating that the control panel is locked. To unlock the control panel, reinsert the lock card. The lock symbol  is then turned off.

## SIGMA GALAXY/FLEX<sup>2</sup> Key lock card

Press the highlighted key pad in the Machine setup menu to select one of the three lock levels.

At level 1, the following functions are locked:

- Menu
- DUO Plus™
- Pulse welding

At level 2, the same functions as at level 1 are locked. In addition, the following functions are locked:

- Current / wire feed speed / thickness of material
- Tack welding
- MIG Manager
- Dialog
- Analog remote control



At level 3, the same functions as at level 2 are locked.

In addition, the following functions are locked:

- Trim voltage / voltage / choke

Irrespective of the chosen lock level, you can operate the welding machine from a robot interface and use the following functions:

- Inching
- Gas test
- Change of sequence (both from panel and trigger).
- 2-stroke/4-stroke

When you insert the lock card, the lock symbol  is displayed, indicating that the control panel is locked. To unlock the control panel, reinsert the lock card. The lock symbol  is then turned off.

